



[SPACIA™ series] C11.5

OWNER'S MANUAL & INSTALL GUIDE

CI1.5 IN A SHEETROCK CEILING

[BOX CONTENTS]

1 SPEAKER • 1 GRILLE • 1 PAINT MASK • 1 HOLE TEMPLATE • 1 EUROBLOCK CONNECTOR

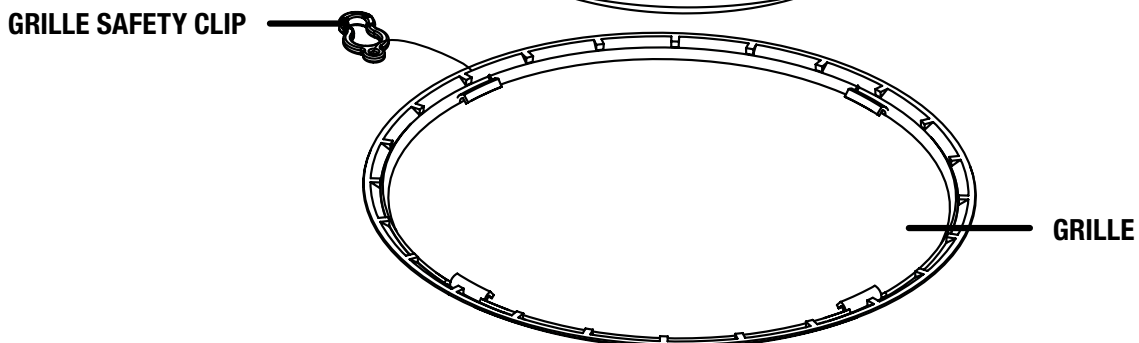
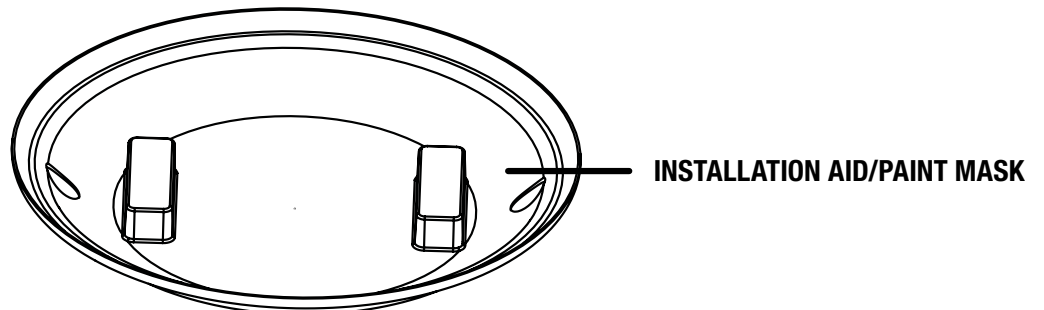
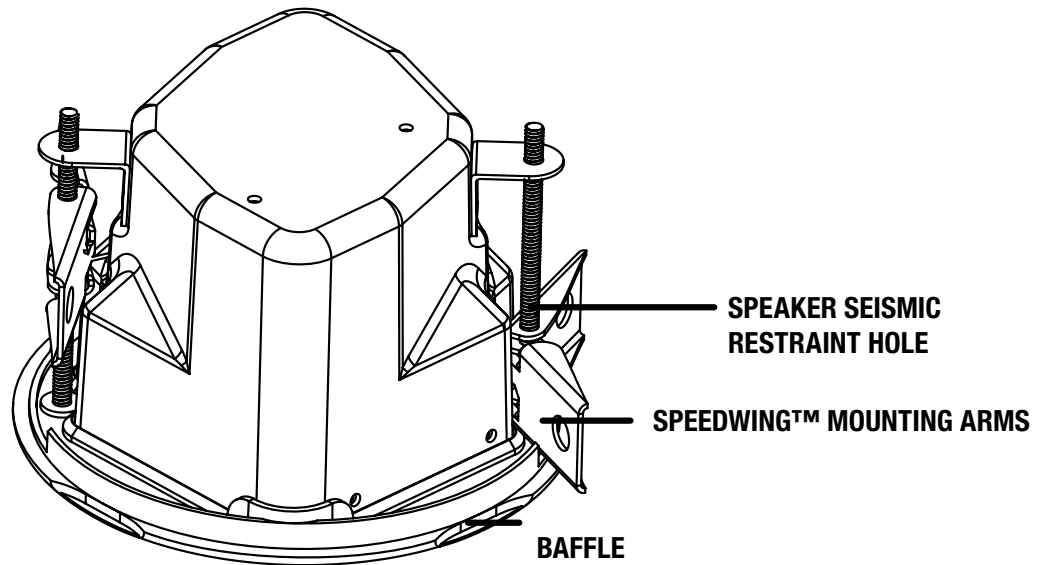



Thank you for choosing Phase Technology® speakers. We know there are a wide variety of choices available today, and we sincerely appreciate your purchase of our product. Phase Technology speakers are built to exacting standards and will provide many years of listening enjoyment.

Our speakers are the result of over five decades of designing and manufacturing. We hold many key patents in loudspeaker technology including the soft-dome tweeter. Our mission, our passion is to constantly advance the art and science of accurate audio reproduction. Our dedication insures your new speakers will accurately reproduce all the impact, detail and delicacy of today's digital technology.

Regardless of application, serious audiophile listening or home theater, we recommend that you take the time to read this manual thoroughly before connecting speakers to your amplifier or receiver. In the highly unlikely event that you should experience a problem with set-up or operation, please contact one of our authorized dealers for assistance, or contact us directly.

Phase Technology Corporation
8005 W. 110th St., Suite 208
Overland Park, KS 66210
855.663.5600 (Domestic)
+1.913.663.5600 (International)
Fax: 913.663.3200

[SPACIA™ series] CI1.5

| | |
|--|----------|
| SAFETY INSTRUCTIONS | 4 |
| ABOUT YOUR CI SPEAKER | 5 |
| GETTING STARTED AND PRECAUTIONARY NOTES | 5 |
| CARING FOR YOUR SPEAKERS | 5 |
| MAINTENANCE AND SERVICE | 5 |
| INSTALLATION IN A SHEETROCK CEILING | 6 |
| INSTALLATION USING AN OPTIONAL BRACKET | 7 |
| WARRANTY | 8 |
| SPECIFICATIONS | 8 |

[SAFETY INSTRUCTIONS]

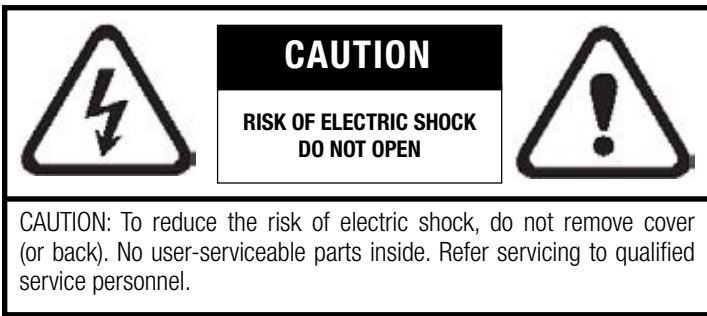

Explanation of Graphical Symbols



The lightning flash with arrowhead symbol, within an equilateral triangle, is intended to alert you to the presence of un-insulated "dangerous voltage" within the product's enclosure that may be of sufficient magnitude to constitute a risk of electric shock to persons.



The exclamation point within an equilateral triangle is intended to alert you to the presence of important operating and maintenance (servicing) instructions in the literature accompanying the appliance.

1. Read Instructions - All the safety and operating instructions should be read before the appliance is operated.

2. Retain Instructions - The safety and operating instructions should be retained for future reference.

3. Heed Warnings - All warnings on the appliance and in the operating instructions should be adhered to.

4. Follow Instructions - All operating and other instructions should be followed.

5. Water and Moisture - The appliance should not be used near water - for example, near a bathtub, washbowl, kitchen sink, laundry tub, in a wet basement, or near a swimming pool, etc.

6. Carts and Stands - The appliance should be used only with a cart or stand that is recommended by the manufacturer.

PORTABLE CART WARNING



7. Wall or Ceiling Mounting - The appliance should be mounted to a wall or ceiling only as recommended by the manufacturer.

8. Ventilation - The appliance should be situated so that its location or position does not interfere with its proper ventilation. For example, the appliance should not be situated on a bed, sofa, rug, or similar surface that may block the ventilation openings; or placed in a built-in installation, such as a bookcase or cabinet

that may impede the flow of air through the ventilation openings.

9. Heat - The appliance should be situated away from heat sources such as radiators, stoves, or other appliances that produce heat.

10. Power Source - The appliance should be connected to a power supply only of the type described in the operating instructions or as marked on the appliance.

11. Power Cord Protection - Power supply cords should be routed so that they are not likely to be walked on or pinched by items placed up or against them, paying particular attention to cords at plugs, convenience receptacles, and the point where they exit from the appliance.

12. Cleaning - The appliance should be cleaned only as recommended by the manufacturer.

13. Nonuse Periods - The power cord of the appliance should be unplugged from the outlet when left unused for a long period of time.

14. Object and Liquid Entry - Care should be taken so that neither objects fall nor liquids spill into the inside of the appliance.

15. Damage Requiring Service - The application should be serviced by qualified service personnel when:

- the power supply cord or the plug has been damaged,
- objects have fallen onto or liquid has been spilled into the appliance,
- the appliance has been exposed to rain,
- the appliance does not appear to operate normally or exhibits a marked change in performance, or
- the appliance has been dropped or the cabinet damaged.

16. Servicing - The user should not attempt to service the appliance beyond those means described in the operating instructions. All other servicing should be referred to qualified service personnel.

17. Grounding or Polarization - Precautions should be taken so that the grounding or polarization means of an appliance is not defeated.

APPLICABLE FOR USA, CANADA OR WHERE APPROVED FOR USAGE

CAUTION: TO PREVENT ELECTRIC SHOCK, MATCH WIDE BLADE PLUG TO WIDE SLOT, INSERT FULLY.

ATTENTION: POUR EVITER LES CHOCS ELECTRIQUES, INTRODUIRE LA LAME LA PLUS LARGE DE LA FICHE DANS LA BORNE CORRESPONDANTE DE LA PRESE ET POUSSER JUSQU'AU FOND.

[ABOUT YOUR CI1.5 SPEAKER]

Thank you for purchasing Phase Technology CI custom installation speakers. This eighth generation of high performance ceiling mounted speakers features the same superb sonic performance as our acclaimed Premier Collection Series cabinet speakers in addition to great exibility and easy installation. The most striking change to the series VIII is a new look with the o-axis tweeter design. This feature maximizes the speaker's clarity and imaging by creating an asymmetrical loading or diraction pattern, reducing the amount of diraction normally caused by a ange-to-ceiling junction.

The net result is the best sonic realism you can buy in an in-ceiling speaker. All CI speakers include self-resetting solid-state PTC protection circuits. This unique system is able to detect when the speaker is being over-driven and lowers the speaker volume until the problem is corrected. The PTC device then resets itself for normal operation. Other features include liquid-cooled tweeters for greater power handling, moisture-resistant materials in all of the critical speaker components, galvanized steel speaker grilles and stainless steel hardware for improved corrosion resistance.

[GETTING STARTED AND PRECAUTIONARY NOTES]

For proper connection and therefore full enjoyment of your new Phase Technology speakers, we encourage you to read this owners' manual thoroughly, even if you are very familiar with installing speakers.

Speaker placement is very subjective. Placement follows the guidelines for the developers of in-ceiling speakers, yet is also guided by personal preferences. The proper spacing, location and adjustment of in-ceiling speakers are critical for complete enjoyment of your new speakers. This manual covers these topics thoroughly.

When deciding upon a location, consider the following:

Make certain your speaker wires can be run to or are accessible from these locations. Make certain the wall or ceiling material is sturdy enough to support the weight and vibration of the speakers. It is recommended that our pre-construction rough-in bracket assemblies be used whenever possible in new construction (not included; AC-CI1.5-PCB). Make certain the area behind the speaker is free of obstacles such as wallstuds, electrical wiring, pipes, etc. Each speaker should be positioned properly, relative to the listening areafor good coverage. Audio performance and room-to-room isolation will be improved if there is some fiberglass insulation placed loosely behind the speaker.

[CARING FOR YOUR PHASE TECHNOLOGY SPEAKER]

All Phase Technology speakers are finished with a high degree of craftsmanship in either hand polished paint or vinyl laminates. We recommend using a lint-free rag with a small amount of glass cleaner to maintain the long-lasting beauty of the finish. Avoid products containing silicones, oils, oil derivatives, or solvents. Enclosures finished in vinyl laminates may be cleaned with a damp cloth as necessary.

[MAINTENANCE AND SERVICE]

Because of Phase Technology's uncompromising quality control programs, it's unlikely that your speakers will ever need service if connected and used as outlined in this Owners' Manual. In the unlikely event that a problem does occur, please contact your Phase Technology dealer. Your dealer has the necessary factory-authorized parts and trained technicians to quickly restore your speaker to its original performance specifications.

[C11.5 INSTALLATION IN A SHEETROCK CEILING]

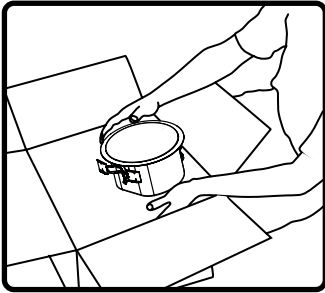

1. Unpack speaker. Leave paint mask in place until after speaker is installed or painting is complete.

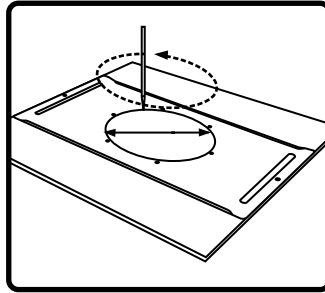

2. Use hole template to mark cutout on sheetrock.

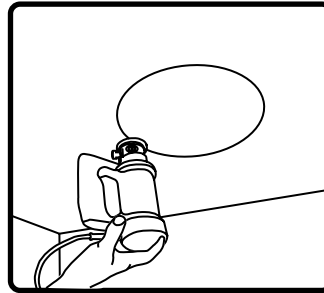

3. Use RotoZip or other tool to cut hole. Hole diameter: 5.6 in.

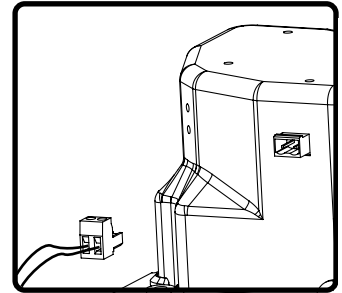

4. Connect Euroblock to speaker wires and connect to speakers.

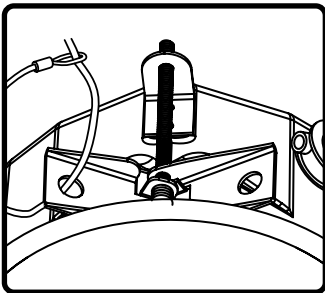

5. If required, attach seismic restraint system to hole in clamping arm, then to reinforced structure (saftey cable not included)

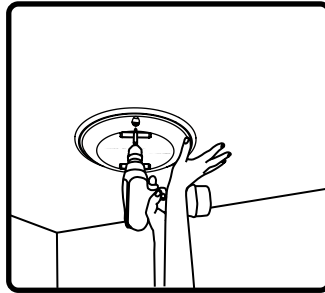

6. Insert speaker into mounting hole with paint mask in place. Tighten both screws on the baffle face to actuate the mounting wings. Firmly secure both screws. **DO NOT OVERTIGHTEN.**

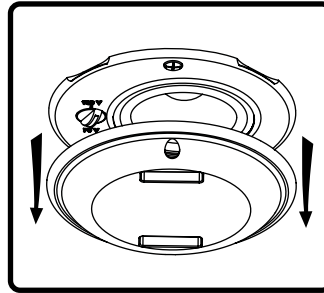

7. Remove paint mask unless painting is required. In that case, follow steps 8-11 when painting is complete.

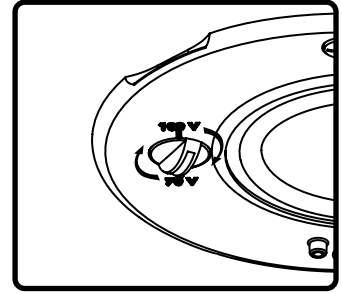

8. Adjust tap switch to proper setting. Switch is preset to 8 Ohm mode.

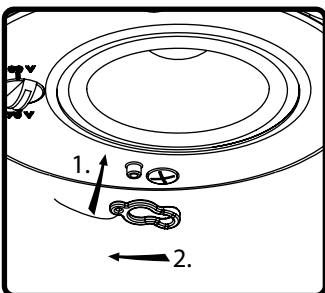

9. Attach grille safety clip by placing the large end of the clip over snap-fit post (1), then sliding clip until small end snaps into place around post (2).

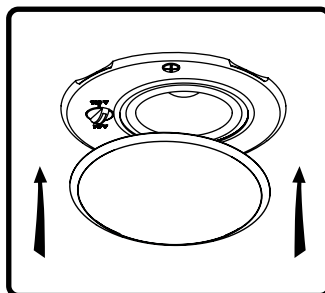

10. Align tabs on snap-fit grille with slots in baffle. Gently press grille into place.

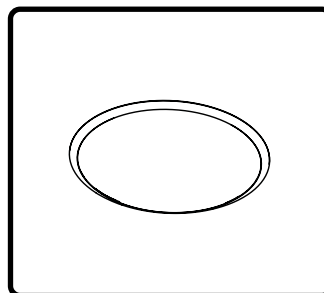

11. **DONE!**

[C11.5 INSTALLATION USING OPTIONAL PRE-CONSTRUCTION BRACKET]

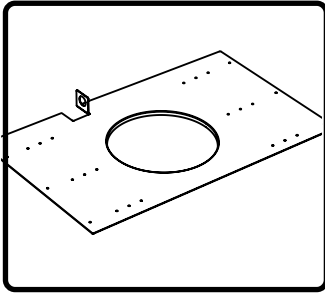

1. Nail or screw bracket to joists.

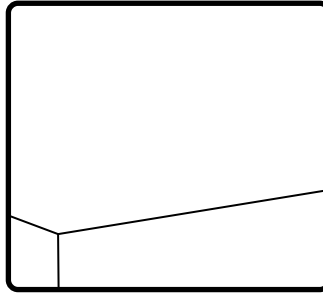

2. Finish installing ceiling.

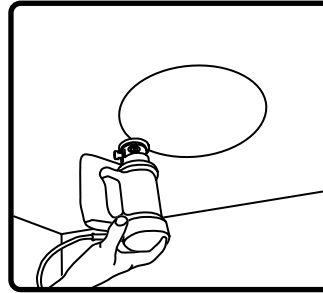

3. Use RotoZip or other tool to cut hole. Hole diameter: 5.6 in.

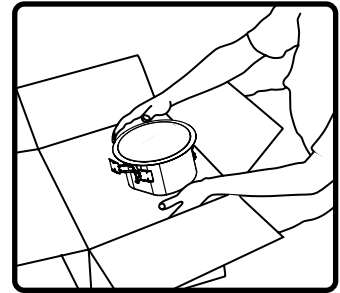

4. Unpack speaker. Leave paint mask in place until after speaker is installed or painting is complete.

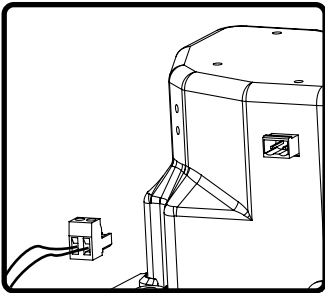

5. Connect Euroblock to speaker wires and connect to speakers.

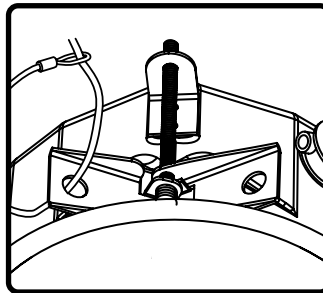

6. If required, attach seismic restraint system to hole in clamping arm, then to reinforced structure (saftey cable not included)

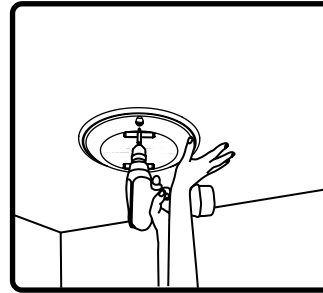

7. Insert speaker into mounting hole with paint mask in place. Tighten both screws on the baffle face to actuate the mounting wings. Firmly secure both screws. DO NOT OVERTIGHTEN.

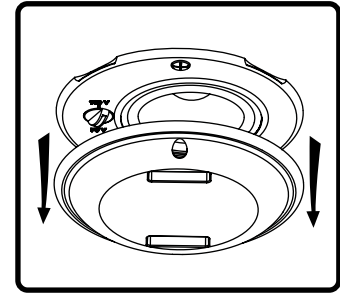

8. Remove paint mask unless painting is required. In that case, follow steps 8-11 when painting is complete.

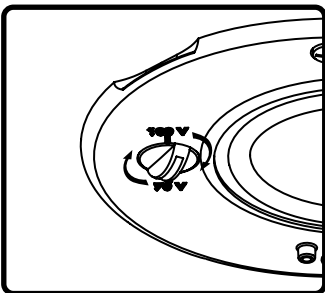

9. Adjust tap switch to proper setting. Switch is preset to 8 Ohm mode.

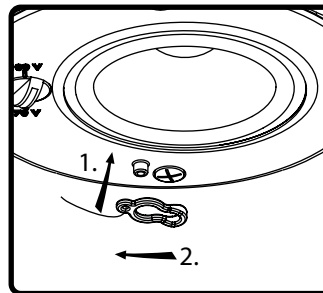

10. Attach grille safety clip by placing the large end of the clip over snap-fit post (1), then sliding clip until small end snaps into place around post (2).

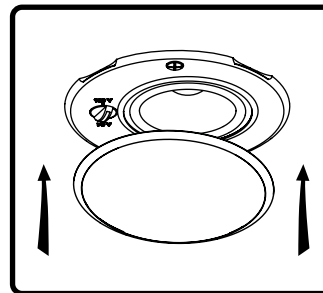

11. Align tabs on snap-fit grille with slots in baffle. Gently press grille into place.

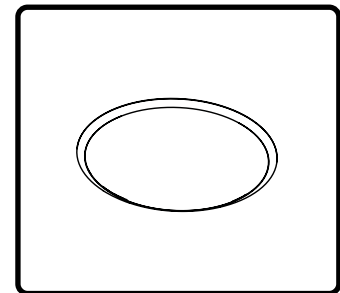

12. DONE!

