

AdderLink X-DVI

Digital video and USB extenders



CONTENTS

Contents



Welcome

Important link cable advice	2
What's in the box.....	3
What you may additionally need	3

Installation

Connections	4
Mounting the modules – desk or rack.....	4
Connections at the local module	5
Connections at the remote module.....	6
Video image compensation	7
Performing upgrades	8

Operation

Operation.....	10
General use	10
Video display (EDID) information	10
Power and activity indicators.....	10

Further information

Troubleshooting	11
Getting assistance.....	11
Warranty	12
Safety information	12
Radio Frequency Energy.....	13

CONTENTS

WELCOME

INSTALLATION

OPERATION

FURTHER
INFORMATION

Welcome



Thank you for choosing the AdderLink X-DVI extenders. These compact modules present the quickest way to extend high quality DVI digital video plus USB keyboard and mouse up to 50 metres away from your computer.

Thanks to our long involvement and investment in extender technology we have succeeded in overcoming the numerous problems associated with extending digital video signals. Using our proprietary transmission techniques the X-DVI

modules can reliably transfer video rates up to 165Mpixels per second. This is in addition to two USB channels for keyboard and mouse - all via the same single length of Category 5, 5e or 6 twisted pair cabling.

The AdderLink X-DVI extenders have been designed to be quick to install and totally transparent in operation. All connectors are industry standard and the video adjustments are made using simple keyboard button presses.

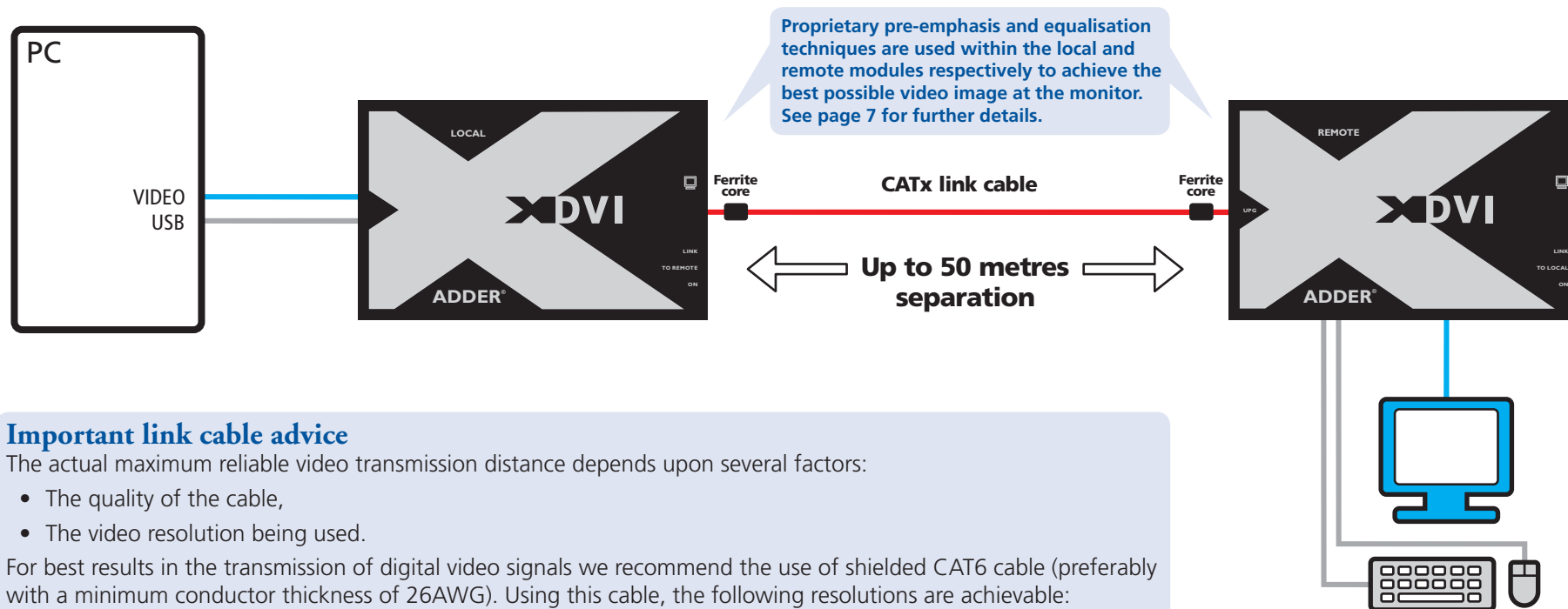

Important link cable advice

The actual maximum reliable video transmission distance depends upon several factors:

- The quality of the cable,
- The video resolution being used.

For best results in the transmission of digital video signals we recommend the use of shielded CAT6 cable (preferably with a minimum conductor thickness of 26AWG). Using this cable, the following resolutions are achievable:

- 1600x1200@60Hz (162Mpixels/second) at least 30m,
- 1920x1200@60Hz, reduced blanking (154Mpixels/second) at least 30m,
- 1920x1080@60Hz HDTV 1080p, reduced blanking (139Mpixels/second) at least 30m,
- 1280x1024@60Hz (108Mpixels/second) at least 40m,
- 1024x768@60Hz (65 Mpixels/second) at least 50m.

CAT6 or better UTP cable will typically enable the above distances to be increased by 10 metres, however, the use of UTP cable is not guaranteed to meet emissions regulations at all screen resolutions and may be affected by external interference. CAT5 / CAT5e UTP cable will enable transmission distances that are equivalent to CAT6 shielded cable. Cables with thicker wires will generally give better performance (i.e. 24AWG is better than 26AWG).

INSTALLATION ADVICE – Connect the supplied protective ferrites at each end of the CATx link cable and avoid disconnecting the CATx link cable whilst the product is operational (powered on).

CONTENTS

WELCOME

INSTALLATION

OPERATION

FURTHER INFORMATION

What's in the box



AdderLink X-DVI local and remote modules

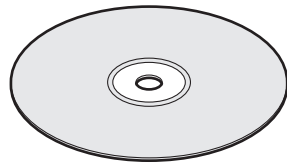

CD-ROM

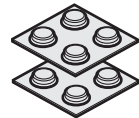

Eight self-adhesive rubber feet

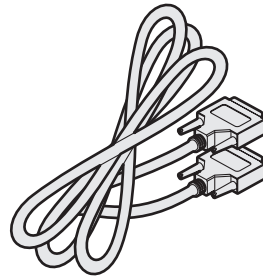

Video cable DVI/D to DVI/D

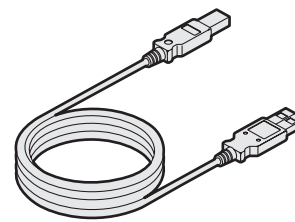

USB cable 2m (type A to B)



Two ferrite cores

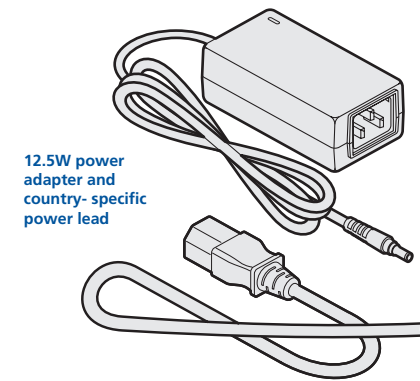

12.5W power adapter and country-specific power lead

What you may additionally need

Power adapter and country-specific power lead for local module (if powering via the USB port is not possible)
Part number: PSU-IEC-5VDC-2.5A

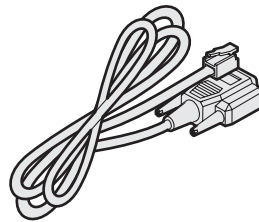
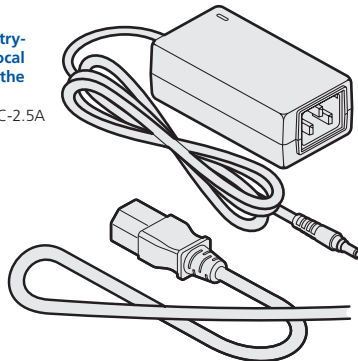

Serial upgrade cable
9-way D female to RJ-9
Part number: CAB-9DF-RJ9-2M

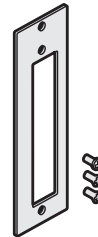

Rack mount plate plus three screws
Part number: MET-XSERIES-FASCIA-SINGLE



Replacement ferrite core
Part number: HAR-CHOKE-74271633

Ferrite core release key
Part number: HAR-RELEASE-KEY

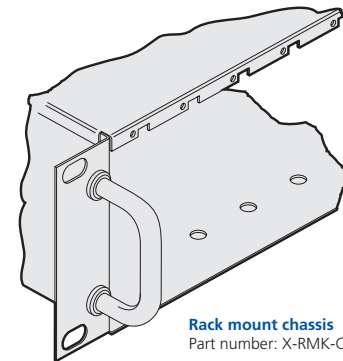

Rack mount chassis
Part number: X-RMK-CHASSIS

Installation



Connections

Installation of the X-DVI modules is straightforward and requires minimal configuration in most cases.

- [Connections at the local module](#)
- [Connections at the remote module](#)

Note: After all connections are made, power up the monitor connected to the remote module, then power up the remote module and finally switch on the computer connected to the local module.

INSTALLATION ADVICE – Connect the supplied protective ferrites at each end of the CATx link cable and avoid disconnecting the CATx link cable whilst the product is operational (powered on).

Switch settings

Both modules have a block of four mini switches located on their side panels. All switches should remain OFF at all times during normal operation. Switch 1 on the remote module is used to place both modules into upgrade mode. All other switches are not used and should remain OFF at all times.

Mounting the modules – desk or rack

The X-DVI modules can be situated on a desk or alternatively, for larger installations, mounted within an optional rack mount chassis.

Desk mount

Apply the supplied self-adhesive rubber feet to the underside of the module.

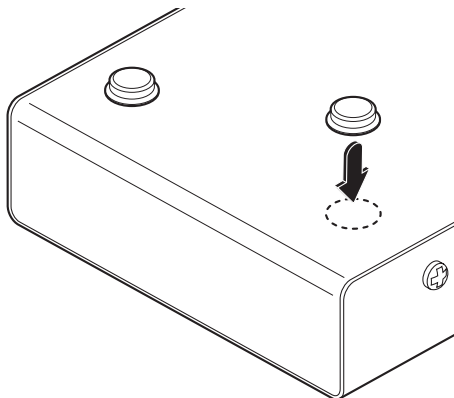

Rack mount

Note: The module switches are not accessible once it is inserted into the rack, therefore, check all settings before insertion.

- 1 Place the rack securing plate (available as a separate kit) onto the front of the module and secure it with the two countersunk screws.
- 2 Orient the X-DVI module on its side so that its labelled face is the correct way up.
- 3 Slide the module into the required rack position. The rectangular cut-out in the front upper lip of the rack allows the two screws on the module's upper edge to slide through.
- 4 The rack mount chassis has a series of holes in its floor that are spaced to accommodate the two screws on the module's lower edge. Ensure that the screws correctly locate into the two holes of the chosen slot. The rack securing plate on the module should now be flush with the front of the rack mount chassis.
- 5 Use the third (pan-head) screw, in the top hole of the rack securing plate to fasten the module to the rack.

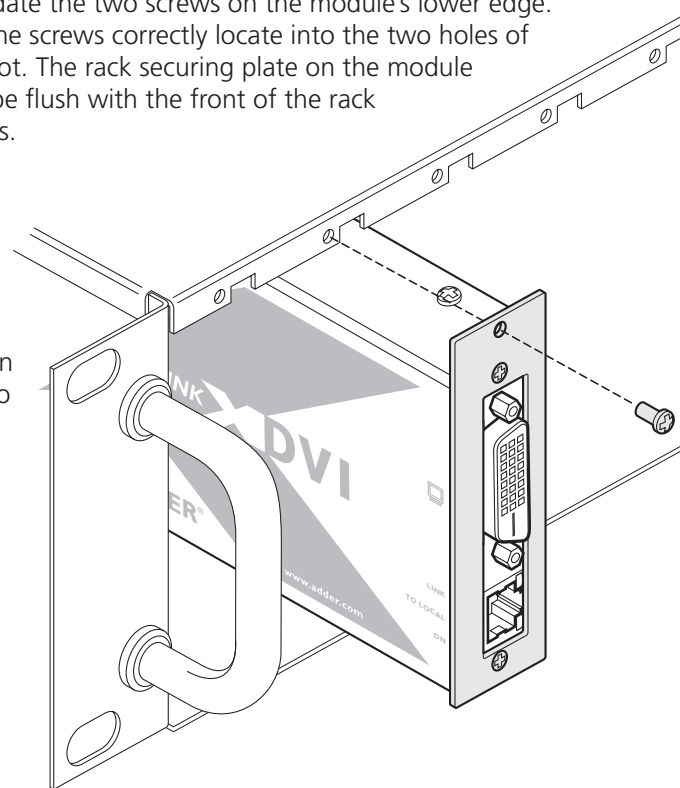

CONTENTS

WELCOME

INSTALLATION

OPERATION

FURTHER INFORMATION

Connections at the local module

Video connection

- 1 Use the supplied DVI/D link cable to connect the DVI input socket of the local module to the digital video output socket of the computer.

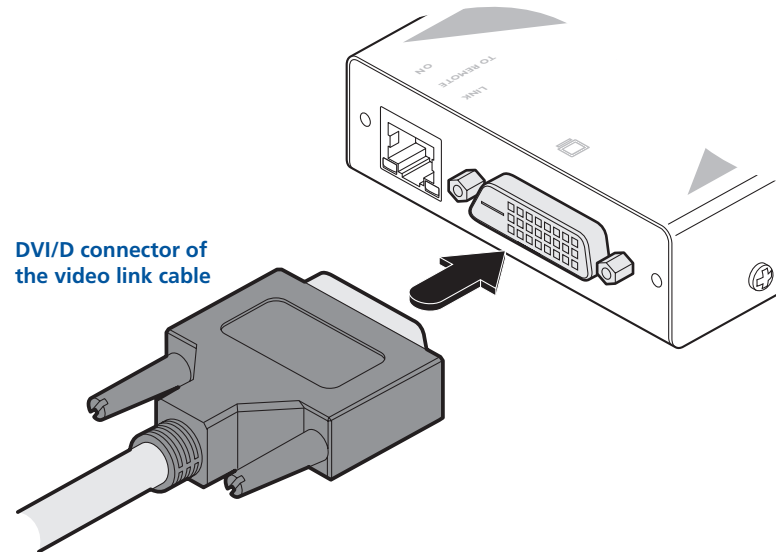

USB connection

- 1 Use the supplied USB cable to link the USB socket of the local module to a vacant USB socket on the computer.

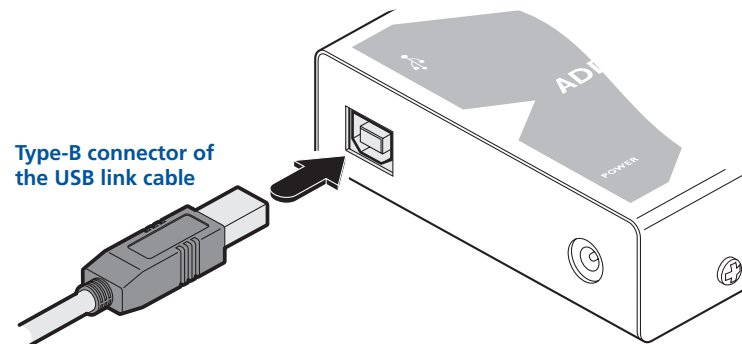

Link connection

- 1 Attach one of the supplied ferrite cores to the link cable, next to the connector. This is necessary to ensure compliance with the European EMC directive and FCC regulations.
- 2 Connect the link cable (see page 2 for cable advice) to the local module socket labelled **TO REMOTE**.

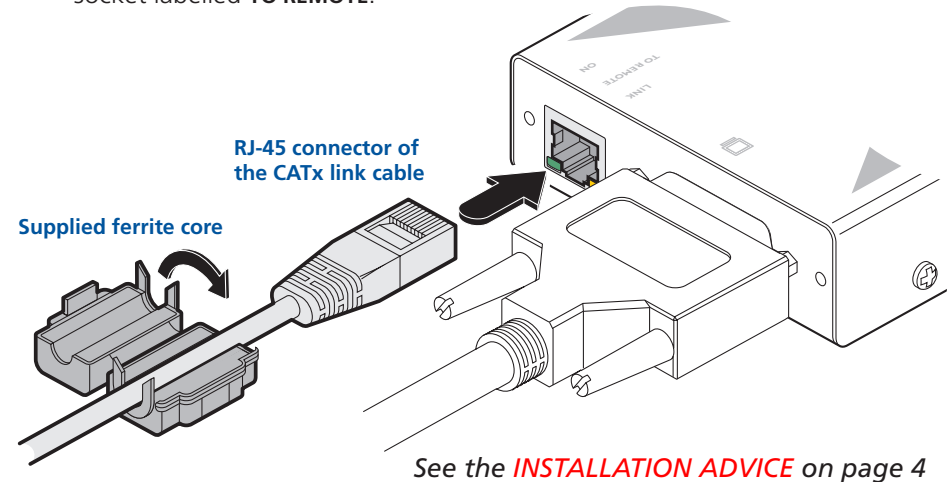

Power connection

The local module is designed to derive its power from the host computer via the USB connection. If this is not possible, then use an optional Adder power adapter.

- 1 Connect the output lead of the optional power adapter to the socket labelled '**POWER**' on the local module.
- 2 Insert the IEC connector of the separate power lead into the corresponding socket of the power adapter. Connect the other end of the power lead to a nearby mains socket.

Note: After all connections are made, power up the monitor and remote module before, followed the local module, and then switch on the computer.

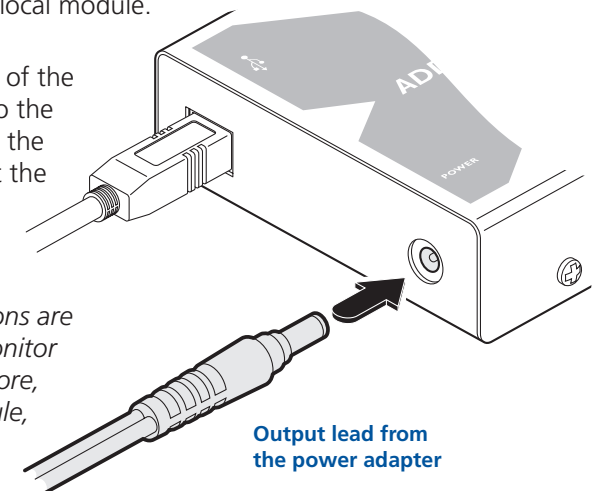

Connections at the remote module

Video connection

- 1 Connect the DVI/D lead from the video monitor to the DVI output socket of the remote module.

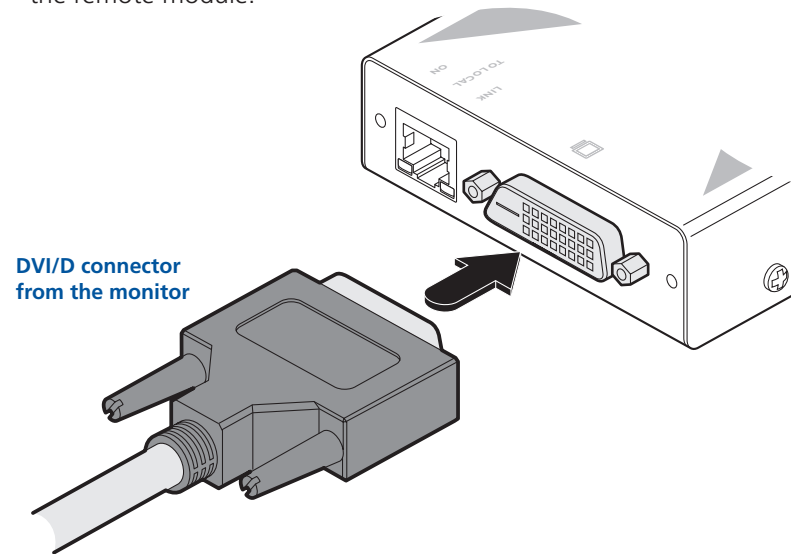

USB connection

- 1 Connect the leads from the keyboard and mouse to the two USB sockets on the remote module.

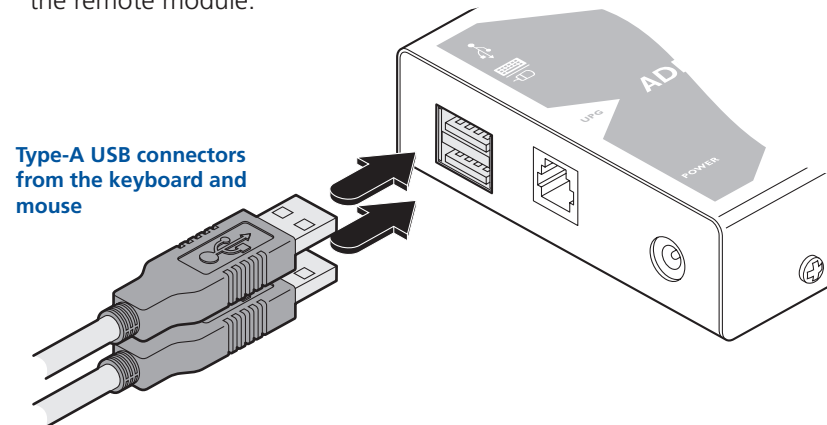

Link connection

- 1 Attach one of the supplied ferrite cores to the link cable, next to the connector. This is necessary to ensure compliance with the European EMC directive and FCC regulations.
- 2 Connect the link cable (see page 2 for cable advice) to the remote module socket labelled **TO LOCAL**.

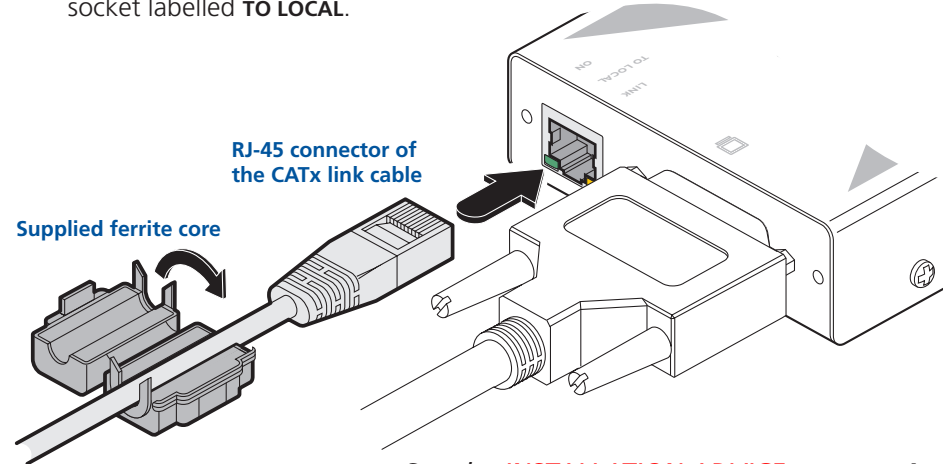

See the **INSTALLATION ADVICE** on page 4

- 3 If necessary, use video compensation to overcome the effects of long cable lengths on the video signal - see page 7 for details.

Power connection

- 1 Connect the output lead of the supplied power adapter to the socket labelled **'POWER'** on the remote module.
- 2 Insert the IEC connector of the separate power lead into the corresponding socket of the power adapter. Connect the other end of the power lead to a nearby mains socket.
- 3 After all connections are made, power up the monitor and remote module and then switch on the computer.

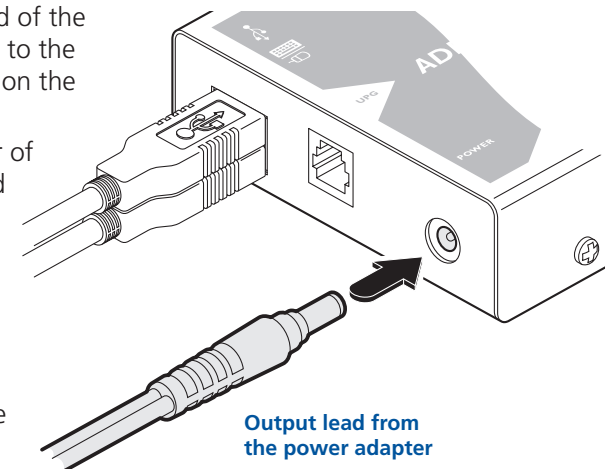

Video image compensation

The X-DVI modules use a special two-part compensation technique to overcome the effects of long cable lengths upon the digital video signal. Under your control, the local and remote modules apply their own adjustments to the video signal. The local module applies *Pre-emphasis* to the video signal while the remote module uses *Equalisation* to return the signal to levels suitable for use at the connected DVI monitor.

Using the keyboard connected to the remote module, you can choose from eight different video compensation settings (each setting affects both the local and remote modules) to achieve the best results. In certain cases there may be no image at the remote monitor until the appropriate compensation setting is chosen.

Note: The effects of video compensation will only be noticeable on longer link cables lengths and/or higher video resolutions.

To adjust the video image

- 1 Connect the X-DVI modules to the computer and peripherals as discussed earlier in this chapter. Power on the remote module and switch on the computer.
- 2 On the keyboard connected to the remote module, simultaneously press the **Ctrl** **Shift** and **↓** keys to enter Configuration mode - the three indicators (Num Lock, Caps Lock and Scroll Lock) on the keyboard should flash slowly in sequence.
- 3 Press the **□** key to begin Compensation - the Scroll Lock indicator on the keyboard should flash.

- 4 Press the **1** key to select the first compensation setting. Allow a few seconds to elapse in order to give time for the compensation mode to change and the video monitor time to adjust itself to the new signal.

Note: In some cases the video image may disappear completely as the video monitor fails to decipher the signal. If this occurs, continue to follow these instructions until the best compensation setting is achieved.

- 5 If necessary, repeat step 4 using keys **2** to **8**, remembering to allow a few seconds after each press to allow the modules and video monitor to react.
- 6 When the best video image compensation is achieved, press the **↓** key to save the settings and return to the normal Configuration mode. The three indicators on the keyboard should once again flash slowly in sequence.
- 7 Press the **↓** key again to exit from the Configuration mode.



CONTENTS

WELCOME

INSTALLATION

OPERATION

FURTHER
INFORMATION

Performing upgrades

The X-DVI modules are fully upgradeable via flash upgrades in order to take advantage of Adder's continual drive to improve products. Such upgrades require a Windows-based computer system to be linked via the special upgrade port located on the remote module.

The upgrade process is handled by the KVM Firmware Uploader utility, which is available from the Adder Technology website (www.adder.com) and allows you to check the current revision of the X-DVI modules.

Items required to use the upgrade utility

- Optional serial upgrade cable.
- A Windows-based upgrade computer with an RS232 serial port.
- The latest version of the KVM Firmware Uploader and firmware files for the X-DVI - available from the *Technical Support > Updates* section of the Adder Technology website (www.adder.com).

To use the KVM Firmware Uploader utility

1 - Obtain and run the KVM Firmware Uploader.

Download the latest X-DVI KVM Firmware Uploader from the Adder Technology website and install it on a Windows-based upgrade computer that will be connected to the X-DVI remote module. The files are supplied as a compressed ZIP file. Decompress the ZIP file with an appropriate tool such as WinZip (www.winzip.com) and copy all contained files to the same folder on the upgrade computer.

2 - Connect the X-DVI remote module to the serial port of the computer

With power removed from the remote module, attach the small RJ-9 connector of the optional upgrade cable to the **UPG** socket, located between the USB and power sockets. Connect the other end of the cable to a vacant serial port of the upgrade computer.

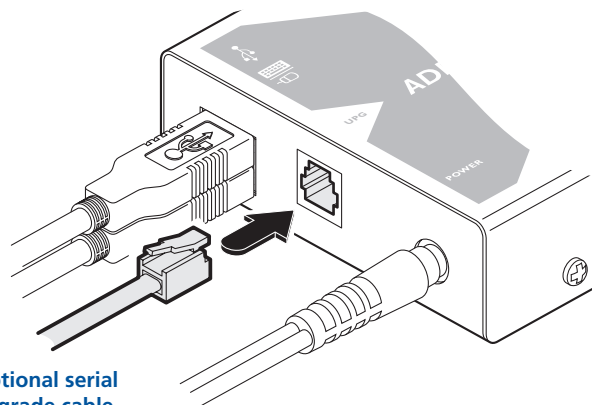

Optional serial upgrade cable

Note: There is no need to change the serial port settings of the upgrade computer, this will be handled by the KVM Firmware Uploader application.

3 - Ensure that the local module is connected to the remote module

In the normal manner, check that the local and remote modules are connected using a suitable link cable.

Note: During the upgrade process, both modules require power. The local module can either be powered via its USB socket from an active computer, or by using another standard Adder power supply, similar to the one used by the remote module.

4 - Invoke upgrade mode and power on the modules

Move switch 1 on the remote module to the ON position - all other switches on this module and all switches on the local module should remain OFF. Power up both modules as well as the upgrade computer.

Set remote module switch 1 to ON

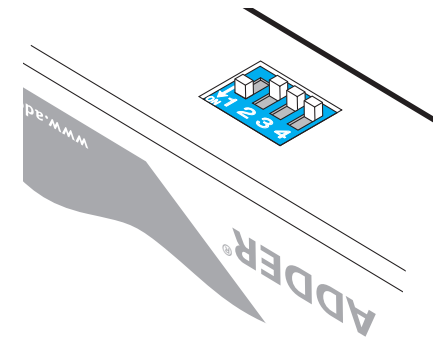

5 - Run the KVM Firmware Uploader utility

From that folder, select the KVMUploader icon to run the upgrade utility. The KVM Firmware Uploader dialog will be displayed:

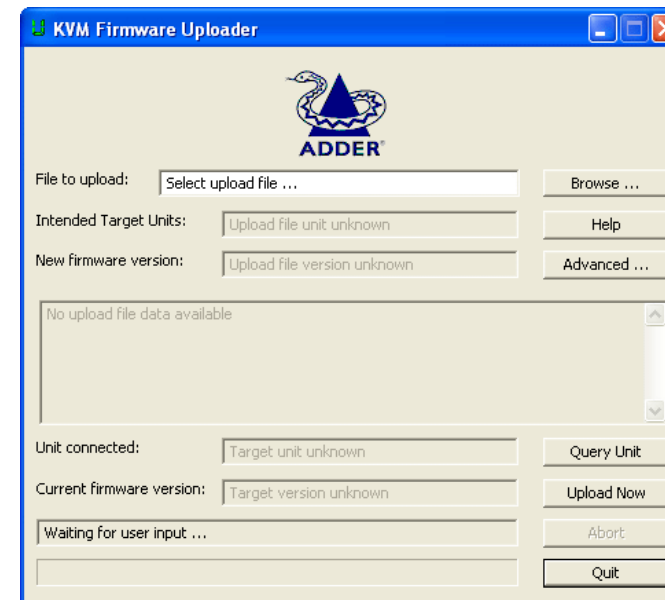

6 - Query the X-DVI modules

Click the *Query Unit* button to confirm that communication is possible with the X-DVI modules and to establish the existing firmware details.

If the application cannot contact the X-DVI modules, re-check the connection cable and click the *Advanced...* button to check that the correct serial port is being used on the upgrade computer. Change the serial port within the *Advanced* section, if necessary.

7 - Select the upgrade file to be used

From the main KVM Firmware Uploader dialog, click the *Browse...* button and select the upgrade file:

X-DVI_x.xx.txt

where x.xx is the firmware version.

The upgrade file details will be displayed within the dialog.

IMPORTANT: Check that the 'Intended Target Units' field matches the 'Unit Connected' field. If these fields do not match then you may have an incorrect upgrade file, check with Adder Technology Ltd before proceeding. Check also that the 'New firmware version' is greater than the 'Current firmware version'.

8 - Commence the upgrade

To begin the upgrade process, click the *Upload Now* button. The progress will be shown within the dialog. Should you decide not to continue with the upload at any stage, click the *Abort* button; response to this is usually immediate, however, during an erase command, the upload will not be aborted until the erase is complete (this may take a few seconds).

The remote module will upgrade its own firmware and also pass upgrade code via the link cable to the local module.

9 - Cycle the power

Disconnect the power. Disconnect the remote module from the upgrade computer and return switch 1 on the remote module to its OFF position. Re-connect the modules in their normal manner. When the power is re-applied the X-DVI modules will operate using the new firmware.

INSTALLATION ADVICE – Connect the supplied protective ferrites at each end of the CATx link cable and avoid disconnecting the CATx link cable whilst the product is operational (powered on).

Issues to consider when performing flash upgrades

The upgrade program rewrites the X-DVI firmware code. If the upgrade process is interrupted then the X-DVI modules will have invalid code and will not be able to operate. It is therefore good practice to ensure that the upgrade process is always fully completed. A partial or failed upgrade may be rectified by performing another upgrade.

WARNING: Running faulty or partially upgraded code may have unpredictable results and may damage your X-DVI modules or computing equipment.



CONTENTS

WELCOME

INSTALLATION

OPERATION

FURTHER
INFORMATION

Operation

Operation

General use

In use, the X-DVI modules should be transparent - the system and its peripherals should operate exactly as normal, the only difference being that they are now up to 50 metres apart.

In some installations, you may see some small flickering of pixels on the screen, particularly at higher screen resolutions. This is due to some portions of the video data being misinterpreted by the video monitor. Assuming that the video monitor is working correctly, this condition is generally caused by a combination of the screen resolution and the length/quality of the link cable. In certain cases, the data misinterpretation can lead to a complete loss of the video image.

If any of the above conditions occur, your first step should be to use the in-built X-DVI video compensation feature to alleviate the situation. See [Video image compensation](#) for details.

Video display (EDID) information

Extended Display Identification Data (or EDID) is an industry standard scheme which allows video monitors to declare their capabilities to the computer's video adapter circuitry, allowing the latter to optimise their outputs accordingly. Since the widespread adoption of the scheme, video adapters have become increasingly dependent on receiving relevant EDID information during startup, before they will output anything more than a rudimentary video signal.

Each time that the remote module is powered on, it attempts to read the EDID information from the connected DVI video monitor. If the attempt is successful, the information is transferred to the local module and stored within non-volatile memory. This information is then made available to the computer's video adapter when required.

Power and activity indicators

Each module provides two indicators to confirm power status and also feedback about the various input signals:

Local module

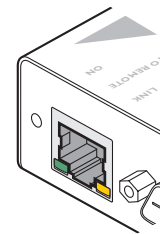

Green:

- On when power is present.

Yellow:

- On when a valid DVI video input signal is being received from the computer.

Flashes regularly (twice per second) when no valid DVI video signal is being received from the computer.

- Off when the CATx link cable is disconnected.
- Blinks in response to inputs from the remote keyboard/mouse.

Remote module

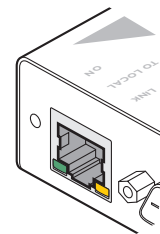

Green:

- On when power is present.

Yellow:

- On when a valid DVI video input signal is being received from the local module.

Flashes regularly (twice per second) when no valid DVI video signal is being received from the local module.

- Blinks in response to inputs from the keyboard/mouse.

Further information



Troubleshooting

If you experience problems when installing or using the X-DVI modules, please check through this section for a possible solution. If your problem is not listed here and you cannot resolve the issue, then please refer to the 'Getting assistance' section.

No video image is displayed on the remote monitor

- Check the yellow indicators on the local and remote modules while no keys are pressed on the keyboard and no mouse movements are being made - both indicators should be continually on when a valid video signal is present.

LOCAL: If the yellow indicator is giving a regular flash (twice per second), then the video feed to the local module is not valid. Try connecting a DVI monitor (preferably using the same DVI link cable as used with the local module) directly to the computer and check for a correct image.

REMOTE: If the yellow indicator is giving a regular flash (twice per second), then the video feed via the link cable is not valid. If the link cable is long, try using a short link cable temporarily to check for basic operation.

If the yellow indicators are off, then the link cable is not properly connected.

- Once you have verified that a valid video signal is present at the remote module, try adjusting the video compensation setting. See [Video image compensation](#) for details.

The video image is showing some small flickering of the pixels

- The combination of cable length and screen resolution may be causing data errors that the video monitor cannot currently resolve. Try adjusting the video compensation setting. See [Video image compensation](#) for details.

Getting assistance

If you are still experiencing problems after checking the list of solutions in the Troubleshooting section then we provide a number of other solutions:

- Adder Technology website – www.adder.com

Check the Support section of our website for the latest solutions and driver files.

- Email – support@adder.com

- Fax in the UK: **01954 780081**
 in the US: **+1 888 275 1117**

- Phone in the UK: **01954 780044**
 in the US: **+1 888 275 3337**

CONTENTS

WELCOME

INSTALLATION

OPERATION

FURTHER
INFORMATION

Warranty

Adder Technology Ltd warrants that this product shall be free from defects in workmanship and materials for a period of two years from the date of original purchase. If the product should fail to operate correctly in normal use during the warranty period, Adder will replace or repair it free of charge. No liability can be accepted for damage due to misuse or circumstances outside Adder's control. Also Adder will not be responsible for any loss, damage or injury arising directly or indirectly from the use of this product. Adder's total liability under the terms of this warranty shall in all circumstances be limited to the replacement value of this product.

If any difficulty is experienced in the installation or use of this product that you are unable to resolve, please contact your supplier.

Safety information

- For use in dry, oil free indoor environments only.
- Do not use to link between buildings.
- Ensure that the twisted pair interconnect cable is installed in compliance with all applicable wiring regulations.
- Do not connect the CATx link interface (RJ45 style connector) to any other equipment, particularly network or telecommunications equipment.
- Warning – the power adapter contains live parts.
- No user serviceable parts are contained within the power adapter - do not dismantle.
- Plug the power adapter into a socket outlet close to the unit that it is powering.
- Replace the power adapter with a manufacturer approved type only.
- Do not use the power adapter if the power adapter case becomes damaged, cracked or broken or if you suspect that it is not operating properly.
- If you use a power extension cord with the units, make sure the total ampere rating of the devices plugged into the extension cord do not exceed the cord's ampere rating. Also, make sure that the total ampere rating of all the devices plugged into the wall outlet does not exceed the wall outlet's ampere rating.
- Do not attempt to service the units yourself.
- The units and power supplies can get warm in operation – do not situate them in an enclosed space without any ventilation.
- The units do not provide ground isolation and should not be used for any applications that require ground isolation or galvanic isolation.



CONTENTS

WELCOME

INSTALLATION

OPERATION

FURTHER
INFORMATION

Radio Frequency Energy

A Category 5 (or better) shielded twisted pair cable must be used to connect the local and remote units in order to maintain compliance with radio frequency energy emission regulations and ensure a suitably high level of immunity to electromagnetic disturbances.

All other interface cables used with this equipment must be shielded in order to maintain compliance with radio frequency energy emission regulations and ensure a suitably high level of immunity to electromagnetic disturbances.

European EMC directive 89/336/EEC



A computing device in accordance with the specifications in the European standard EN55022. These limits are designed to provide reasonable protection against harmful interference.

This equipment generates, uses and can radiate radio frequency energy and if not installed and used in accordance with the instructions may cause harmful interference to radio or television reception. However, there is no guarantee that harmful interference will not occur in a particular installation. If this equipment does cause interference to radio or television reception, which can be determined by turning the equipment on and off, the user is encouraged to correct the interference with one or more of the following measures: (a) Reorient or relocate the receiving antenna. (b) Increase the separation between the equipment and the receiver. (c) Connect the equipment to an outlet on a circuit different from that to which the receiver is connected. (d) Consult the supplier or an experienced radio/TV technician for help.

FCC Compliance Statement (United States)

This equipment generates, uses and can radiate radio frequency energy and if not installed and used properly, that is, in strict accordance with the manufacturer's instructions, may cause interference to radio communication. It has been tested and found to comply with the limits for a class A computing device in accordance with the specifications in Subpart J of part 15 of FCC rules, which are designed to provide reasonable protection against such interference when the equipment is operated in a commercial environment. Operation of this equipment in a residential area may cause interference, in which case the user at his own expense will be required to take whatever measures may be necessary to correct the interference. Changes or modifications not expressly approved by the manufacturer could void the user's authority to operate the equipment.

Canadian Department of Communications RFI statement

This equipment does not exceed the class A limits for radio noise emissions from digital apparatus set out in the radio interference regulations of the Canadian Department of Communications.

Le présent appareil numérique n'émet pas de bruits radioélectriques dépassant les limites applicables aux appareils numériques de la classe A prescrites dans le règlement sur le brouillage radioélectriques publié par le ministère des Communications du Canada.



CONTENTS

WELCOME

INSTALLATION

OPERATION

FURTHER
INFORMATION

© 2009 Adder Technology Limited
All trademarks are acknowledged.
Release 1.0g
February 2009
Part No. MAN-X-DVI

Adder Technology Limited,
Technology House,
Trafalgar Way, Bar Hill,
Cambridge, CB23 8SQ,
United Kingdom
Tel: +44 (0)1954 780044
Fax: +44 (0)1954 780081

Adder Corporation,
29 Water Street,
Newburyport,
MA 01950,
United States of America
Tel: +1-888-932-3337
Fax: +1-888-275-1117

Adder Asia Pacific
6 New Industrial Road,
Hoe Huat Industrial Building
#07-01,
Singapore 536199
Tel: +65 6288 5767
Fax: +65 6284 1150